

\$315,000

99+ Acres of Pasture and Woodland

MLS # 45066-23680



MLS# : 45066-23680

Price : \$315,000

Type : Timberland Property

Size : 99.2 Acres

Address : 000 Doyle Road , DeWitt , Virginia , 23840

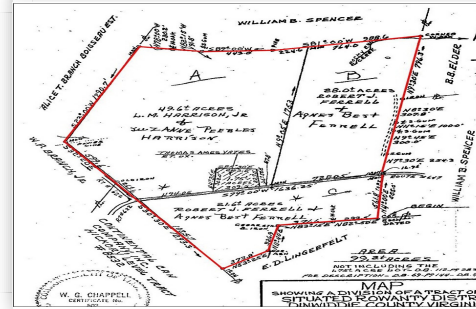

FEATURES

- ✓ 99+ Ac timberland and pasture
- ✓ Fenced pasture land
- ✓ Good hunting
- ✓ Southern VA
- ✓ Option to buy without timber
- ✓ Quiet area of Dinwiddie County
- ✓ Farms-Horses
- ✓ DeWitt, VA

ABOUT THE PROPERTY

Calling All Loggers.....

Timber appraisal is \$80,000 and seller will harvest the timber and reduce the price accordingly. Second option is timber will be included in the list price shown.

This is a nice farm for cattle or for row crops. It has desirable home sites for someone looking to live on the property. The open land is surrounded by mature woods so the buyer has several options.

Fencing is in place and is being rented for cattle grazing. Quiet neighborhood, great hunting with a small stream. Convenient to I-85, Ft. Lee, and Ft. Pickett.

\$315,000.00 Call Today! 804-469-5902 Email: rennieucwor@yahoo.com

CONTACT US

RENNIE BRIDGMAN, JR.

MANAGING BROKER

☎ 8045860840

✉ rennieucwor@yahoo.com

🏠 Virginia Realty

📍 1909 Main St, Victoria, Virginia,
United States, 23974